

## Knock Sensor (KS) — 4.6L (3V)

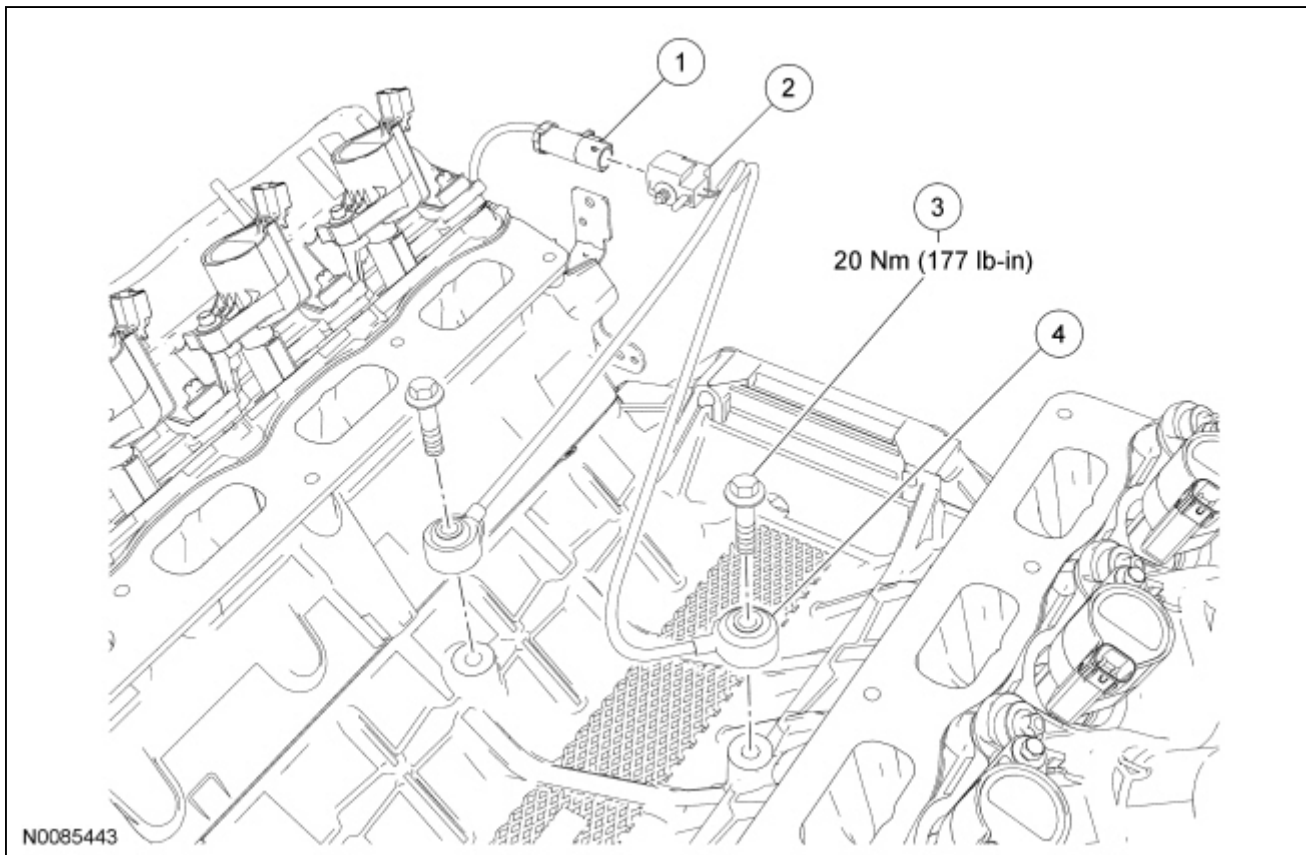

Item	Part Number	Description
1	14A464	Knock Sensor (KS) electrical connector (part of 12B637)
2	—	Pin-type retainer (part of 12A699)
3	W500110	<a href="#">KS</a> bolt (2 required)
4	12A699	<a href="#">KS</a>

### Removal and Installation

1. Remove the intake manifold. For additional information, refer to [Section 303-01B](#).
2. Disconnect the Knock Sensor (KS) electrical connector.
  - Detach the pin-type retainer.
3. Remove the 2 bolts and the [KS](#).
  - To install, tighten to 20 Nm (177 lb-in).
4. To install, reverse the removal procedure.

